

# STL MIKRO

43 W Surface Mounted Single Module  
Linear LED Luminaire

Order Code : 3103459  
Product Code : STL 043U 40OD28 3K5 146TK3I LN5XMC



## Product Data

### Standard Features

Housing	: RAL 7047 Powder finished aluminium extrusion housing, aluminium injection cover
Diffuser	: Glare minimizing highly permeable diffuser
Ceiling Type	: Plasterboard
IP Grade	: IP40
Installation	: Recessed mounted
Light Source	: Mid Power LED

### Optical & Electrical Features

Power Consumption	: 43.1 W
Final Luminous Flux	: 3570.1 lm
Efficacy	: 82.6 lm/W
Input Voltage	: 220-240 24V DC
Frequency	: 50-60 Hz
Power Factor	: > 0,9
Correlated Color Temperature	: 4000K
Color Rendering Index	: >80

\*There is ±%10 tolerance in the technical values.

### Other Features & Conditions

Operating Temperature Range	: -25 °C/+40 °C
Impact Resistance	: IK02
Led Life Time - L70	: > 72.000 hours @Ta= 40 °C

## Photometric Curve

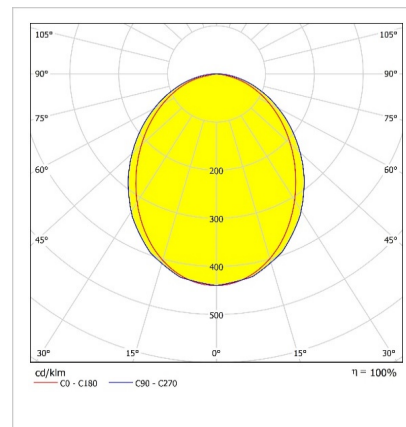

### Optional Features

Correlated Color Temperatures	: 2700K, 3000K
Color Option	: RAL 9005

# STL MIKRO

43 W Surface Mounted Single Module Linear LED Luminaire

3103459 STL 025U 40OD28 1K9 146TK3I LN5XMC

## Dimensions (mm)

	a	b	h
Single Module	1468.5	40	40
Starting Module	1465,5	40	40
Finishing Module	1465,5	40	40
Intermediate Module	1462,5	40	40

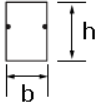
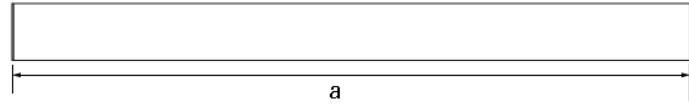

## Weight (kg)

Standard 3

- EAE, reserves the right to make changes without prior notice.



Revision date: 10.02.2020